



*The pleasure of ...
marvelous lifestyle !!!*

A Project By:



Marketed By:



Site Address : Gat No. 126/2, Near Pavana Hospital, Somatane Phata, at Somatane, Tal. Maval, Dist. Pune

Mail : sales@destinyrealtyservices.com Web : www.destinyrealtyservices.com

Call Us : +91 7757 0999 19, +91 7757 0999 20

Note: All specifications, plans, facilities, dimensions etc are subject to the approval of the respective authorities and the developers reserve the right to change the above without any notice or any obligation. Images are for representative purpose only.

1 BHK LUXURIOUS APARTMENT

**KUM KUM
RESIDENCY**



KUM KUM RESIDENCY

Pune is city in the west of India and roughly 160 KM east of Mumbai.

It has winding roads many of which follow the natural slopes of the mountains terrain and end at the rivers feeding the city the measure highways are develops which link the city to the other part of country.

Somatane Phatha is rapidly developing area with beautiful natural surrounding.

Kum Kum residency is situated with such beautiful natural surrounding, having beautifully designed 1 BHK Smart and luxurious Homes.

Project has closed proximity to the Highway, Railway Station, Bus Stop, Cricket Ground, Garden, Stadium, IT Park, MIDC, School Colleges, Shopping Complex & Entertainment malls.

KUM KUM
RESIDENCY

1 BHK LUXURIOUS APARTMENT

Nature
always were the *Colour*
of spirit ...



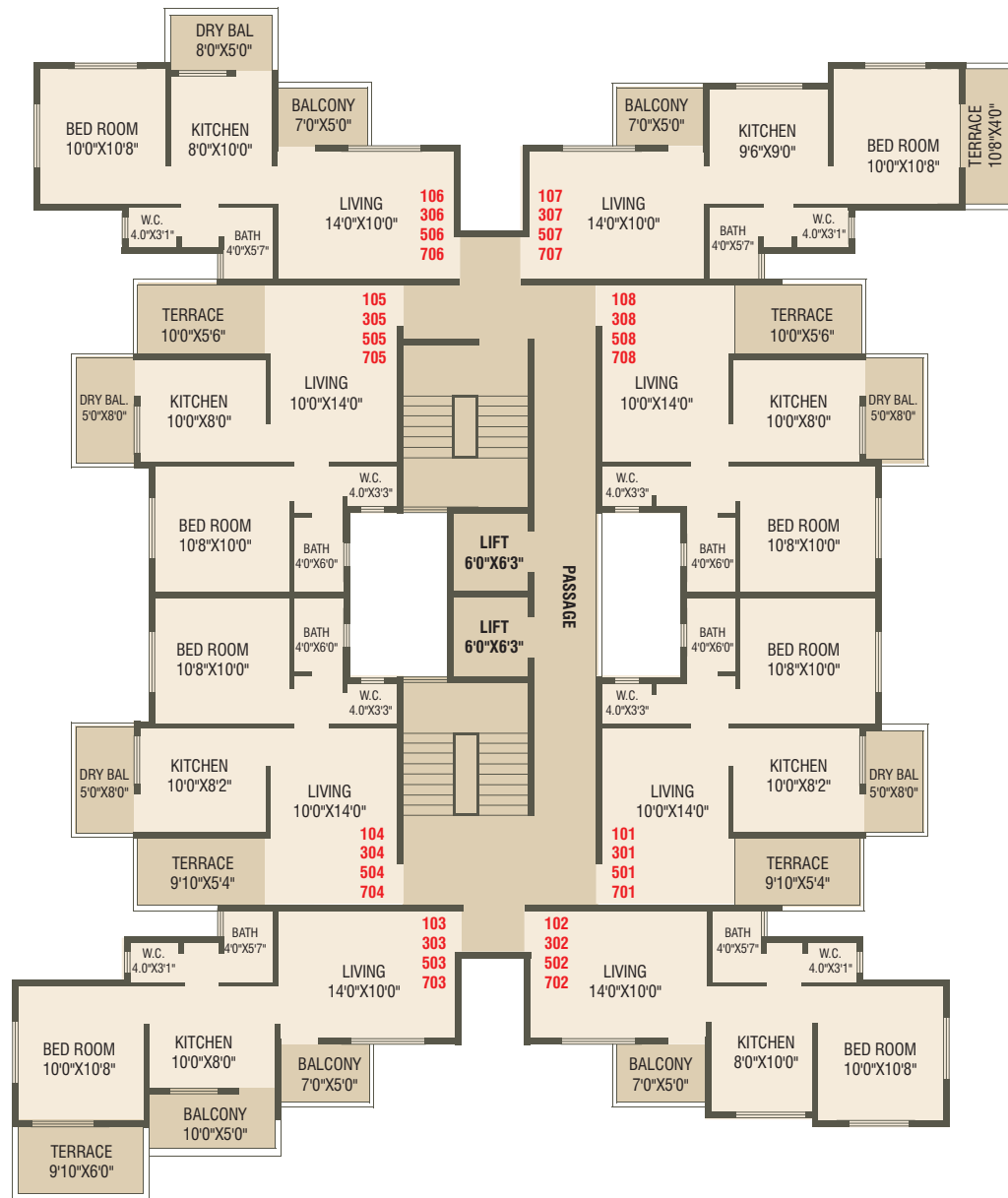

*Come and feel...
Natural Living...*

AMENITIES

- Fire fighting system for each building
- Internal concrete road
- Letter box & name plate for each flat
- Rain water harvesting
- Chequered tiles flooring in parking area
- Sanitation facility for drivers, servants and society staff
- Attractive entrance gate with security cabin
- Solar water heater for each flat

KUM KUM
RESIDENCY

SPECIFICATION

- Construction** : Earthquake resistant RCC Design and frame work.
Walls: 4"/6" Internal & external walls
External sand faced & internal neeru finished.
- Flooring** : 24"x24" vitrified tiles in whole flat.
12"x12" antiskid tiles in toilets & terrace of each flat.
- Toilets** : Concealed CPVC plumbing in all toilets & bathrooms.
12"x18" Designer glazed wall tiles upto 7'0" height.
Hot and cold water mixer for bathrooms
C P fittings, sanitary ware of renowned & leading brand in toilets, bathrooms & kitchens
Master cock to toilets, bathrooms in each flat.
- Door** : Decorative water proof main entrance door with exclusive SS fittings
Water proof flush doors for bedrooms, toilets & terraces.
- Windows** : 1. Powder coated aluminum sliding windows in bedroom with mosquito mesh.
2. Louvers window in toilet & bathroom
- Paints** : 1. Oil painted M.S. safety grills & terrace railing.
2. Internal oil Bound Distemper.
3. External water proof acrylic paints for the entire building.
- Kitchen** : 1. Granite kitchen platform with stainless steel sink with designer glazed wall tiles up to lintel level
2. Provision for water purifier with electrical point in each point
- Electrical** : 1. Connected electric copper wiring of ISI mark
2. T.V point in living room
3. Computer point in master bedroom of each flat
4. Premium quality branded moduler switches
5. Point provision for A.C in master bed room
6. M.C.B with distribution board for safety in each flat
7. Fridge, Mixer electronic point in kitchen
8. Provision for electrical point & drain pipe for washing machine



**KUM KUM
RESIDENCY**

Pavana Hospital : 0.5 km | Talegaon Station : 3.0 km | Hinjewadi IT Park : 13 km | Talwade IT Park : 10 km
Sahara Stadium : 6.0 km | Lonawala : 35 km | PCMC : 10 km

Architect
Precision Architects & Planner

R.C.C. Consultant
Sarvasiddhant Consultants